

# MODEL 3500 LED

## 3500 Field Repairable LED Blast Light

**ABRASIVE BLAST  
LIGHTING**

from **WESTERN TECHNOLOGY**

June 2016

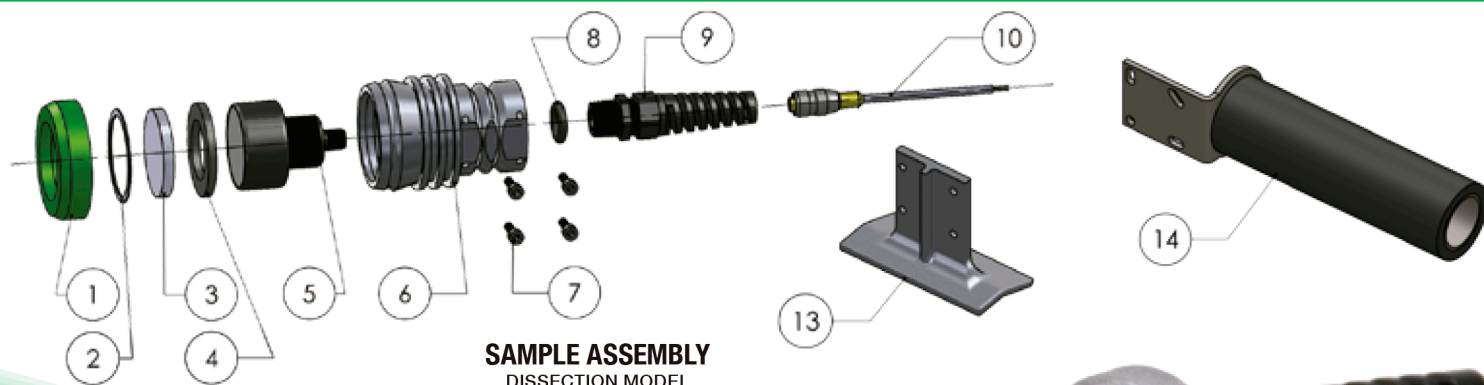

### Product Features

<b>Light Output</b>	<ul style="list-style-type: none"> <li>▶ Light Output: <b>295 Lumens</b></li> <li>▶ Brightness @ 48": <b>3110 Lux @ 8.5" Diameter</b></li> </ul>
<b>Light Source</b>	<ul style="list-style-type: none"> <li>▶ Emitter Type: <b>LED</b></li> <li>▶ Color Temperature: <b>+5500K</b></li> </ul>
<b>Power</b>	<ul style="list-style-type: none"> <li>▶ Power Consumption: <b>~4 Watts</b></li> <li>▶ Voltage Range: <b>12-30 VDC</b></li> </ul>
<b>Housing</b>	<ul style="list-style-type: none"> <li>▶ Light Body: <b>Cast Aluminum</b></li> <li>▶ Length: <b>4 3/8"</b></li> <li>▶ Width: <b>2 5/8"</b></li> <li>▶ Diameter: <b>2 5/8"</b></li> <li>▶ Weight: <b>20 oz.</b></li> </ul>
<b>Accessories &amp; Parts</b> (see Sample Assembly pic)	<ul style="list-style-type: none"> <li>▶ 1: <b>Front Bumper</b> ( Replaceable )</li> <li>▶ 3: <b>Heat Treated Lens-</b> [ 6 Pack of Replacement Lenses (3) ]</li> <li>▶ 2, 4, 5: <b>LED Module Kit</b> ( Replaceable )- [ LED Engine Module(5), Primary Gasket(4), w/Snap Ring (2) ]</li> <li>▶ 5: <b>LED Engine Module-</b> ( Replaceable Module Only)</li> <li>▶ 6: <b>Housing</b></li> <li>▶ 7: <b>Mounting Screws</b></li> <li>▶ 8, 9, 10: <b>Power Kit</b> ( Replaceable )- [ Power Cord Seal (8), Strain Relief Connector (9), 10' Power Cord (10) ]</li> <li>▶ 10: <b>Cord Only</b> ( Replaceable )</li> <li>▶ 13: <b>Hose Mount</b></li> <li>▶ 14: <b>2-Way Soft Grip Mount</b></li> <li>▶ <b>Battery Pack &amp; Accessories:</b> See Back (3510 LED)</li> </ul>

**WTT Western Technology**

